

Eng. Istabraq Al Janabi, B.Sc. CE (Hons), M.Sc. CE, M.ASCE (USA)

Professional Profile Nakheel Corporation PJSC
Palm Island Project Jumeirah and Jebel Ali and Other Projects

Carrier Achievements Illustrating Large Projects
Implemented and Delivered with Images

Program Management - Development Management

“Versatile, and Productive Corporate Level Professional Engineer with over 25 Years’ Lead Experience in Analytical and Operational Presentations of Strategic Direction for Large Mixed-Use Project’s Program and Construction Management”



2003 - 2011

Construction Management and Projects' Development Management



Nakheel Corp. PJSC - Dubai, UAE 2003-2011

- **Infrastructure**
- **Hospitality**
- **Real Estate**
- **Retail**
- **Marine, Environmental Assessment & Conservation**
- **Risk Management & Mitigation Planning**
- **Design Management & Value Engineering**
- **Feasibility Studies, Marketing Studies, Budgeting**
- **Tendering, Contracts, Claims & Claims Management**
- **PMO, Investment Management**

Soil Reclamation for The Palm Island Project, Jumeirah - Dubai

May 2002



September 2002

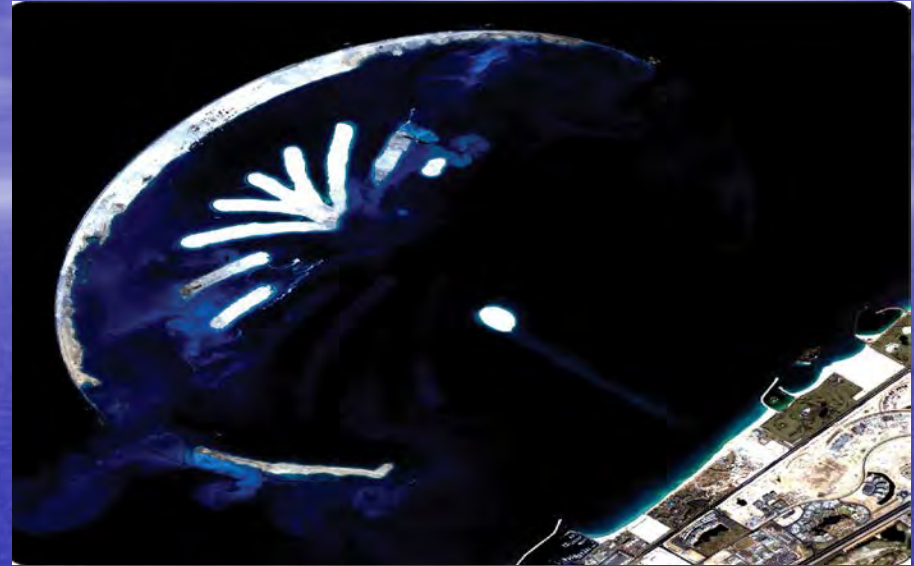

January 2003



May 2003



Construction Management for The Palm Island Project, Jumeirah - Dubai



Zone Load Testing for The Palm Island Project, Jumeirah – Dubai 2004



Periodic Measurement of Settlement for Frond E and Crescent Island for Soil Densification Purposes



Soil Densification Process for The Palm Island Project, Jumeirah – Dubai 2004

Utilization of Vibro Compaction Technique for Soil Densification and Stabilization for All Palm's Fronds and Trunk



Soil Settlement After Vibro Compaction has Reached Down to 1.5 Meters



Construction Management of 800 Villas on the Palm's Fronds and Trunk The Palm Island Project, Jumeirah – Dubai 2004 - 2005

Infrastructure, MEP, Roads/Bridges, Real Estate, Hard and Soft Scape, Environment, Marketing and Value Engineering Studies



Fronde Villas With Detailed Infrastructure, MEP, Rooding, and Landscaping The Palm Island Project, Jumeirah – Dubai 2005



Construction of Shoreline Apartment Buildings (40 Buildings) at The Palm Island Project Trunk Jumeirah, Dubai 2006



Construction of The Palm Island's Metro Piles Jumeirah, Dubai 2006

Foundation Piles Inspection for the Shoreline Apartment Buildings



Construction of Shoreline Apartment Buildings (40 Buildings)

The Palm Island Project Trunk
Jumeirah, Dubai 2006



Construction of Quay Wall in the
Palm's Trunk 2006

Construction of 11 KVA Power Sub-Stations The Palm Island Project 2006



Construction of Underwater Tunnel Between the Palm's Spine and Crescent (800 M. Long) Jumeirah, Dubai 2006



Construction of The Atlantis Hotel & Resort, JV Between Nakheel and Kerzner at the Palm's Crescent Including Ground Densification and Foundation Piling Works 2006



Construction of the Palm's Metro Connecting the Palm Entrance to the Crescent



**Hospitality, Infrastructure,
Marine, Environmental
Conservation, MEP**

Construction of The Palm's Anchor West and East Upper Trunk Marinas

The Palm Island Project. Jumeirah, Dubai, UAE 2007 - 2008



The Palm Island Project. Jumeirah, Dubai, UAE 2007 - 2011

**Nakheel Dubai Based
Off-Shore Projects
Proposed Future Public
Marine Transport Plan
2007**



The Palm Island Project. Jumeirah, Dubai, UAE 2007 - 2011



Strategic Development and Feasibility Studies with International Design Consultants in N.Y., USA for Proposed Ferry Terminals Designs & Locations Linking Coastal Projects with Land.

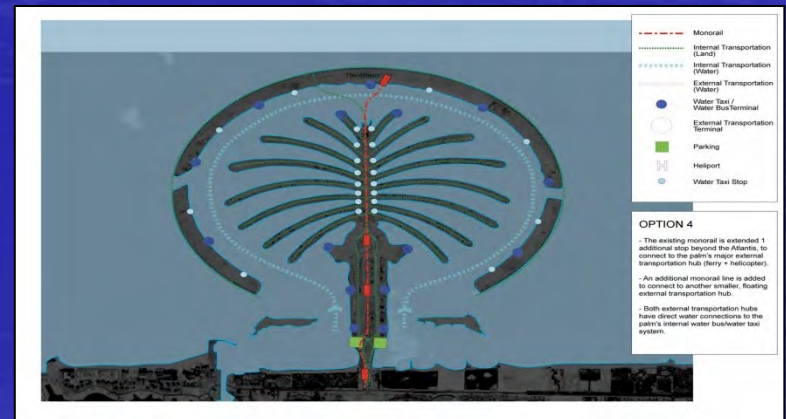

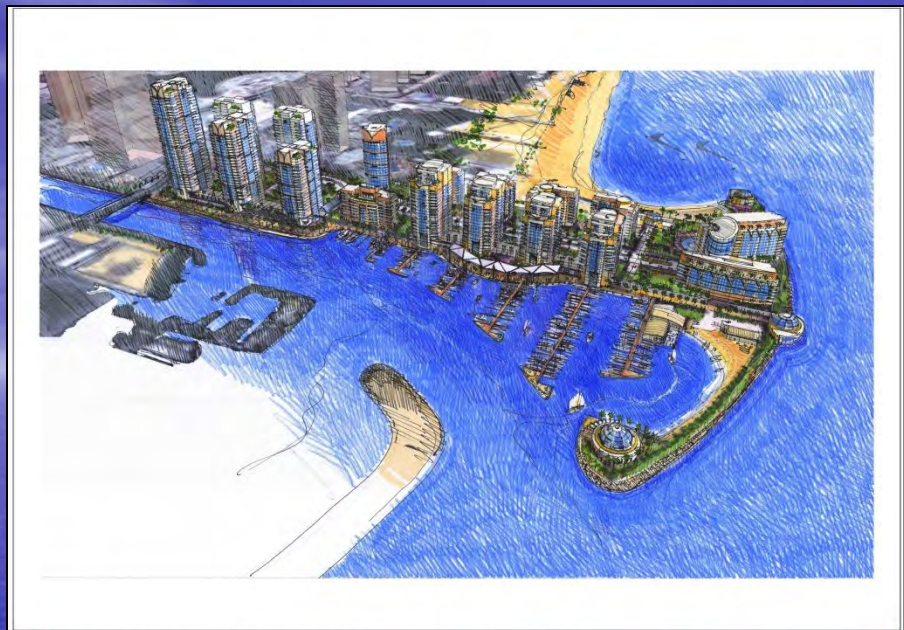

Dubai Promenade Project. Jumeirah, Dubai, UAE 2006
(Environment and Design Concept Analysis (Real Estate, Hospitality, Retail, Marine, Value Engineering, Investment and Marketing))



Dubai Promenade Project. Jumeirah, Dubai, UAE 2006
Soil Reclamation, Ground Densification, Water Protection and Breakwater Construction
(Marine Works, Erosion Protection, Environmental Conservation)





The Palm Island Project and The Central Business District in The Dubai Waterfront Project. Jebel Ali, Dubai. UAE 2005 - 2011 (Infrastructure, Real Estate, Hospitality, Marine, Environment

The Palm Island Project Development Studies. Jebel Ali, Dubai. UAE 2005 - 2011 (Infrastructure, Real Estate, Hospitality, Marine, Environment)

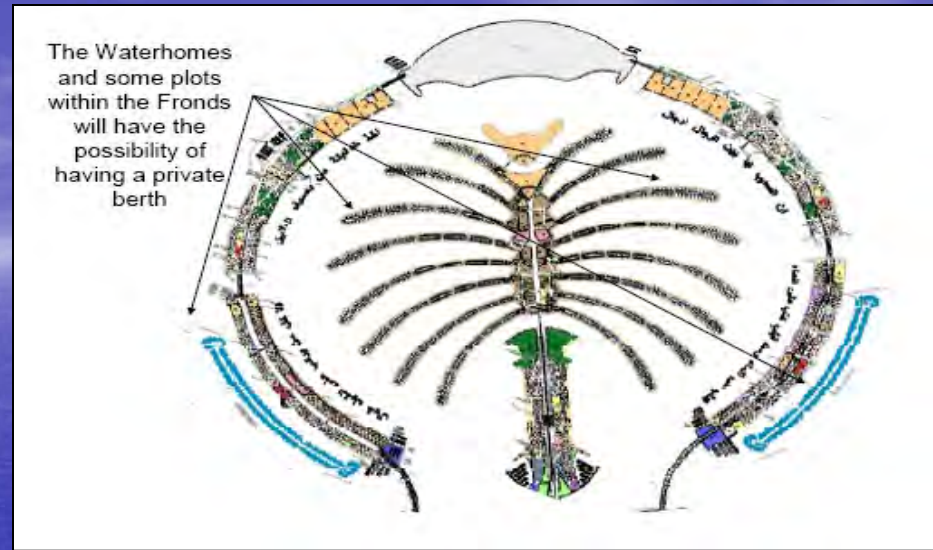
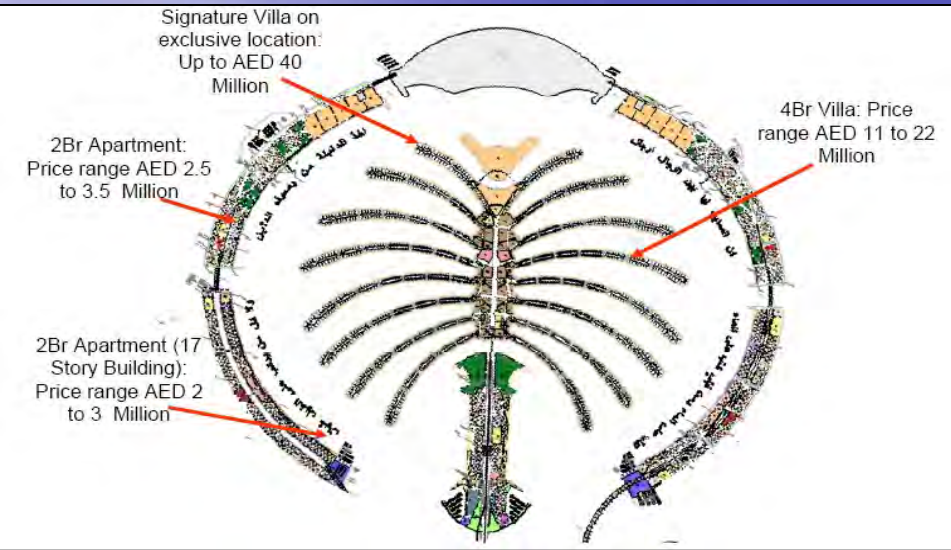

Land Use	Berth Demand	Absorption from Frond-Plots with Private Berth (640 plots with provision to have a berth)	Absorption from Waterhomes (approx 500 homes with provisions to have a berth)	Absorption from available Berths within the Proverb (approx 400 berths available)	Recommended Marina Berths	Slip Mix		
						Class D (5 - 10m)	Class W (11 - 24m)	Class M (>24m)
TRUNK	786	0	-30	0	756	60%	37%	3%
CRESCENT A	683	0	-60	-21	602	49%	49%	2%
CRESCENT B	511	0	-30	-24	457	29%	64%	8%
CROWN	236	0	-22	0	214	0%	68%	32%
CRESCENT D	526	0	-30	-24	472	25%	68%	8%
CRESCENT E	734	0	-60	-21	653	46%	51%	3%
FRONDS AND SPINE	649	-140	0	-12	497	0%	70%	29%
WATERHOMES	52	0	-52	0	0	100%	0%	0%
TOTALS	4,177	-140	-284	-102	3,651	35%	55%	10%

Construction of Bridges and Infrastructure in the Palm Island Project Jebel Ali, Dubai 2005-2011

2008



The World Islands Project Construction Management

(Infrastructure, Marine, Environmental Conservation)

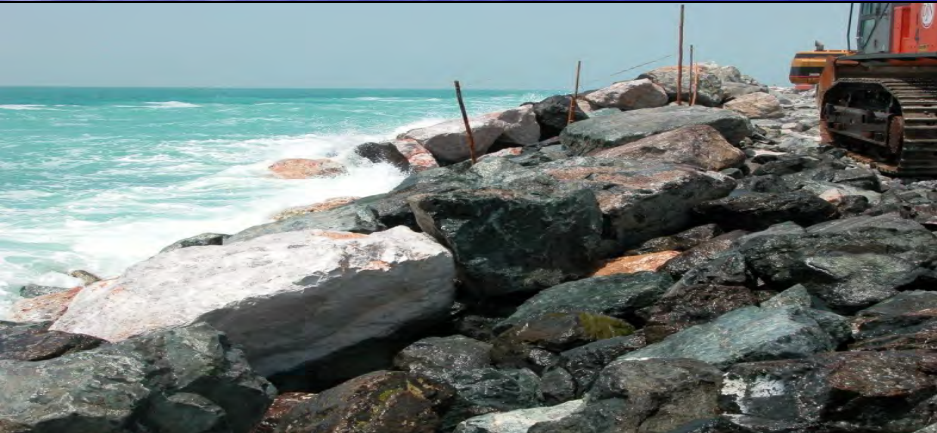

Dubai Creek Marinas Construction Management. Dubai, UAE 2006

Al Seef and Baniyas Marinas Development

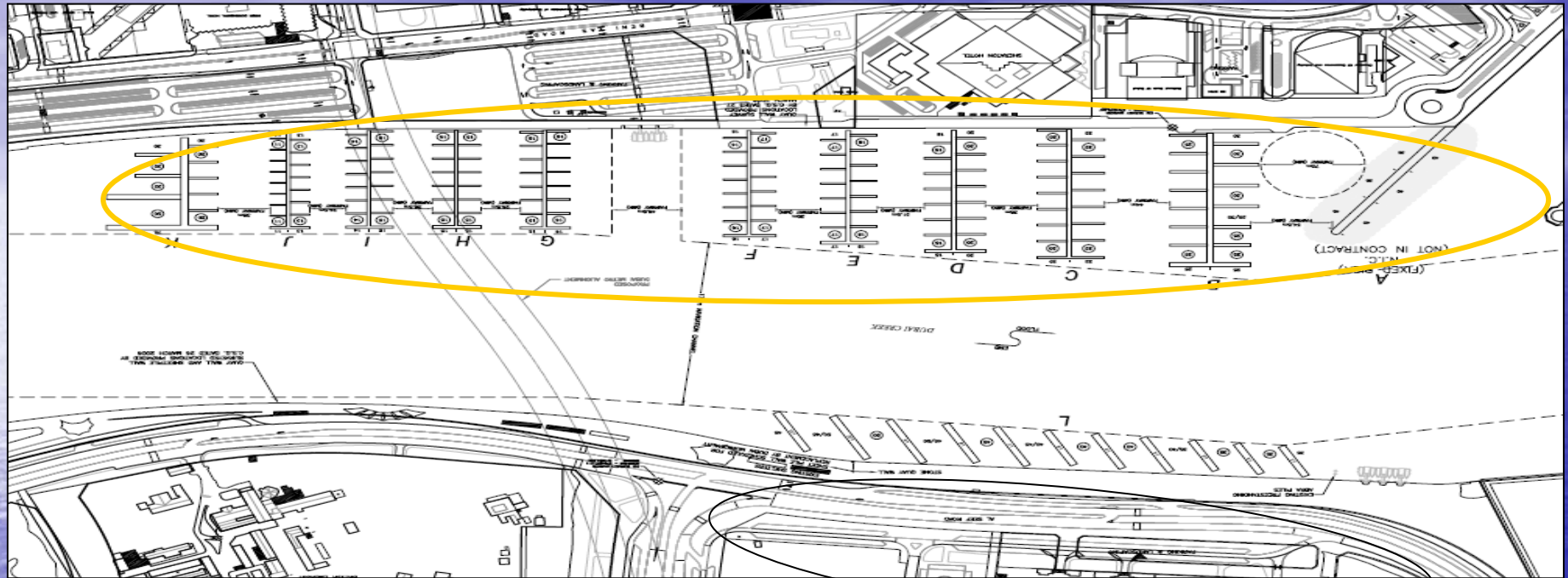

Master Planning and Construction Management. Dubai, UAE 2005

Jumeirah Lake Towers Project Development (Infrastructure, Real Estate)

